

Can Seam Set Up and Adjustment

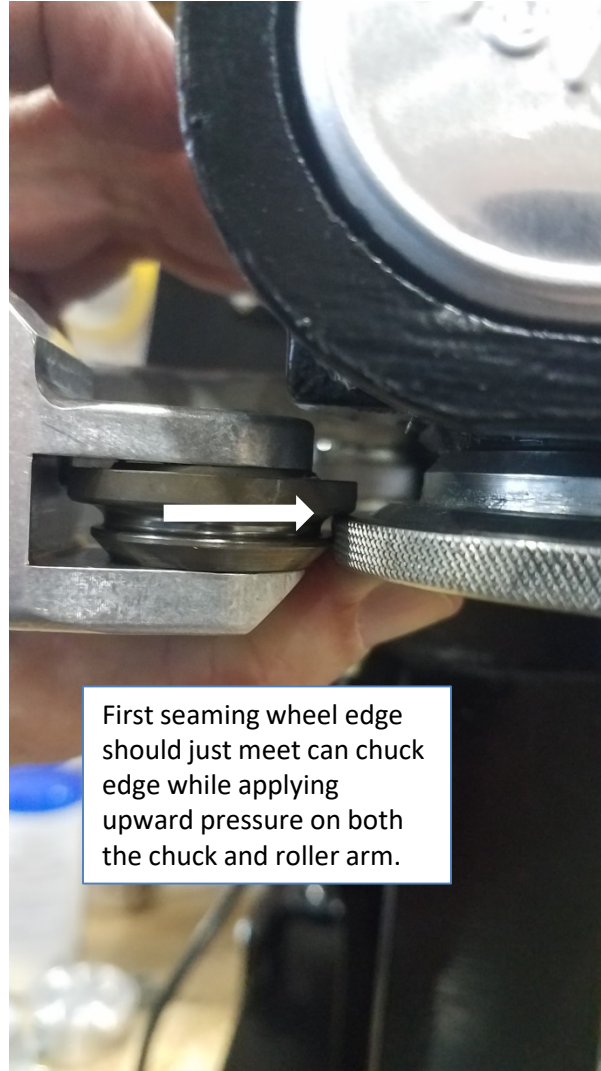

Handle should engage (you feel pressure build) at approximately "2:30" and be then pushed all the way back to assure proper can pressure against can lid chuck.



First seaming wheel edge should just meet can chuck edge while applying upward pressure on both the chuck and roller arm.

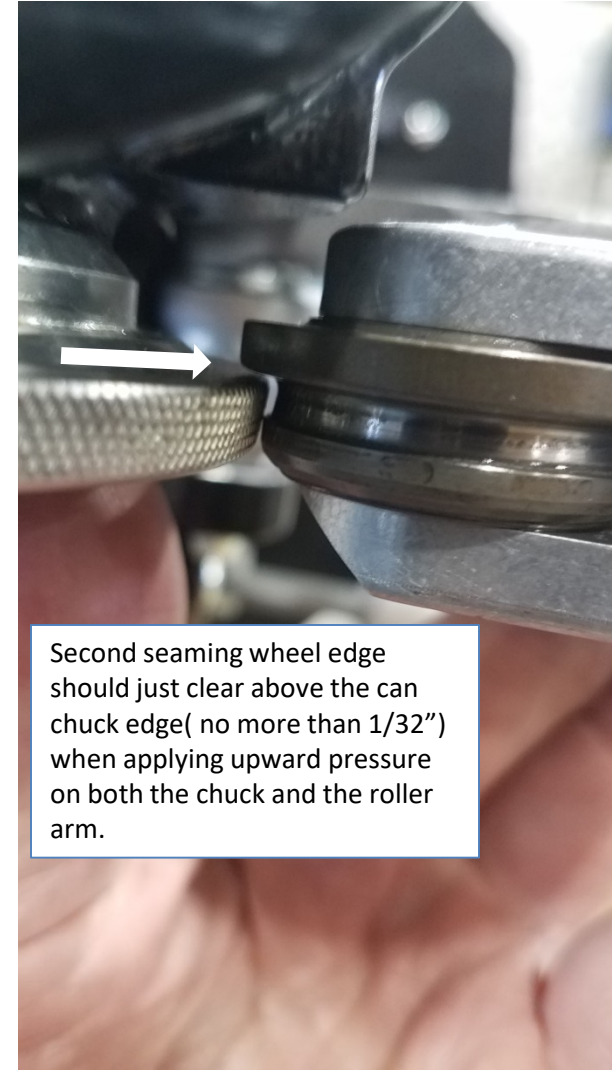

Second seaming wheel edge should just clear above the can chuck edge (no more than 1/32") when applying upward pressure on both the chuck and the roller arm.

Remove pin from the second or right side seam arm, this will disengage the second seam

1

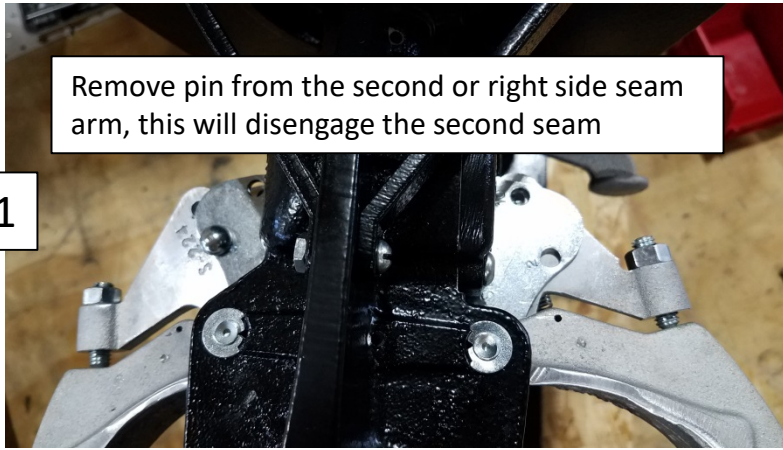

2

Run Seamer to seam the first seam only



3

Measure the first seam width to .108 inches +/- .004

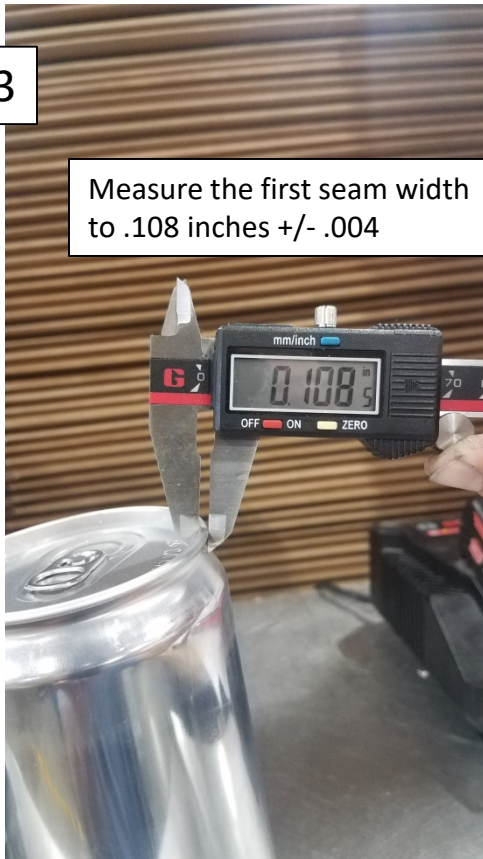

4

If needed loosen jam nut and adjust screw to adjust seam width. Note: make adjustments in small increments



Place the second arm pin back into the 2 position and remove pin from the first or left side seam arm, this will disengage the first seam

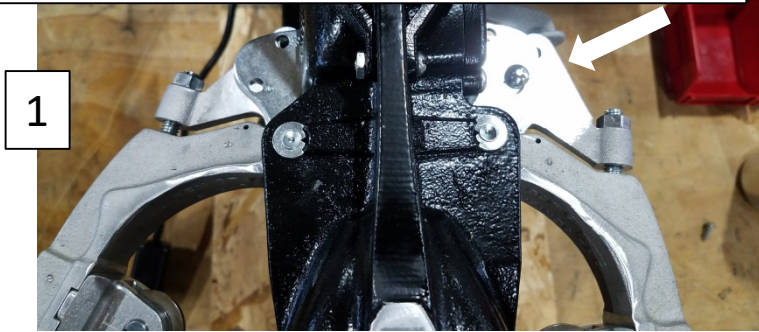

1

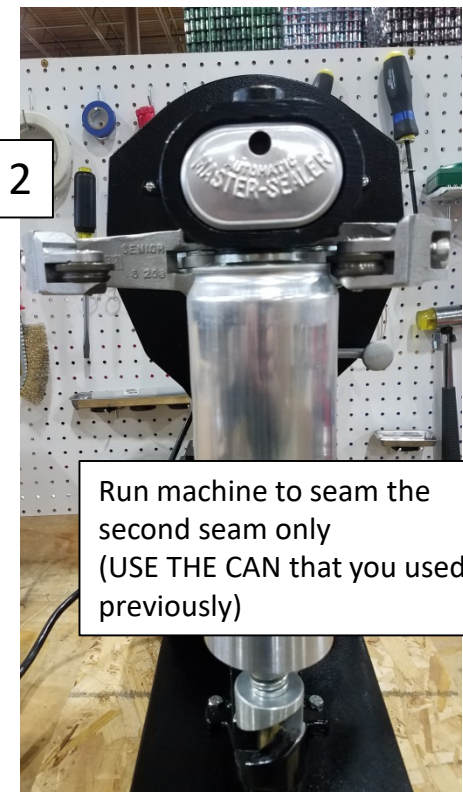

2

Run machine to seam the second seam only (USE THE CAN that you used previously)

3

Measure the first seam width to .066 inches +/- .002



4

If needed loosen jam nut and adjust screw to adjust seam width. Note: make adjustments in small increments

